

# INTEX® OWNER'S MANUAL

## MULTI-COLOR LED POOL SPRAYER

### Model SCL306

READ AND FOLLOW ALL INSTRUCTIONS BEFORE USING THIS PRODUCT

## ⚠ WARNING

- Assembly and disassembly by adults only.
- This is not a toy. Do not allow children to play with this product.
- Never grab, pull, push, lean on or obstruct the sprayer at any time.
- Ensure all the clamp screws, adaptor A and hose are securely attached.
- This product is intended to be used only for the purposes described in the manual.

**FAILURE TO FOLLOW THESE WARNINGS AND THE ASSEMBLY AND USE INSTRUCTIONS MAY RESULT IN SERIOUS INJURY, DROWNING OR PROPERTY DAMAGE.**

### PARTS LIST

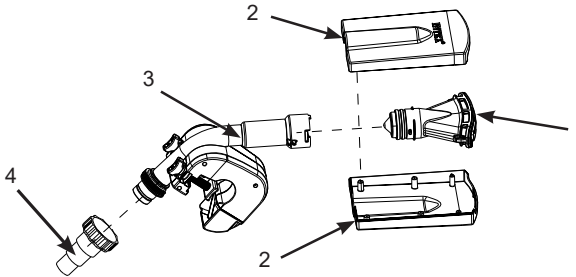

**NOTE:** Drawings for illustration purpose only. May not reflect actual product. Not to scale.

REF. NO.	DESCRIPTION	QTY.	SPARE PART NO.
1	Sprayer head set	1	12273
2	Top & bottom cover with screws set	1	12272
3	Sprayer clamp with screws	1	12280
4	Adaptor A	1	10849

©2023 Intex Marketing Ltd. - Intex Development Co. Ltd. - Intex Recreation Corp. All rights reserved/Tous droits réservés/Todos los derechos reservados/Alle Rechte vorbehalten. Printed in China/Imprimé en Chine/Impreso en China/Gedruckt in China.

®™ Trademarks used in some countries of the world under license from®™ Marques utilisées dans certains pays sous licence de/Marcas registradas utilizadas en algunos países del mundo bajo licencia de/Warenzeichen verwendet in einigen Ländern der Welt in Lizenz von/ Intex Marketing Ltd. to/à/aran Intex Development Co. Ltd., Hong Kong & Intex Recreation Corp., P.O. Box 1440, Long Beach, CA 90801 • Distributed in the European Union by/Distribué dans l'Union Européenne par/Distribuido en la unión Europea por/Vertrieb in der Europäischen Union durch/Intex Trading B.V., Ettenseweg 46, 4706 PB Roosendaal – The Netherlands • Distributed in the UK by Unites Service (UK) Limited, 21 Holborn Viaduct, London EC1A 2DY, UK. [www.intexcorp.com](http://www.intexcorp.com)

# INTEX®

## SAVE THESE INSTRUCTIONS

**General**

- No tools are required for the assembly.
- Fits all round and rectangular Metal Frame and Ultra Frame pools (not suitable for Easy Set, Oval and Panel pools).
- Built-in hydroelectric generator powers the LED light, no batteries or electrical connection required.
- Lights in 3 colors: red, blue and green. Preset 10 seconds between color change. Best seen at night or under low light condition.
- Pump flow rate required: 3,785-12,112 L/h (1,000-3,200 gph). System flow rate required: 2,271-7,570 L/h (600-2,000 gph).
- Make sure the pump and the pool are setup and filled with water first.
- Remove the sprayer before placing a pool cover over the pool.
- When not in use remove from the pool and store in a safe place indoors.
- For pool and filter pump problems refer to their respective owner's manual.

**Setup**

1. Place the sprayer clamp over the selected horizontal top beam of the metal frame pool, within reach of the filter pump return hose, and tighten the clamp screws by hand. See fig (1).

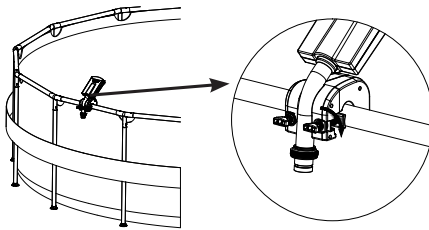

FIG (1)

**2. For filter pump with 38mm (1.5 in) hose and plunger valve:**

- a) Turn off the filter pump, close the inlet plunger valve, and disconnect the pump return hose (from pump to pool) from the inlet plunger valve.
- b) Attach the pump return hose directly to the sprayer inlet. See fig (2). Turn on the filter pump.

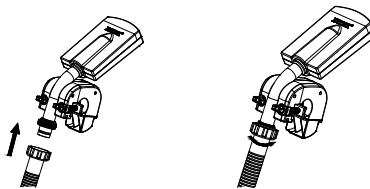

FIG (2)

# SAVE THESE INSTRUCTIONS

**3. For filter pump with 32mm hose (1.25 in):**

- a) Turn off / unplug the filter pump, cover the inlet fitting from inside of the pool to prevent water from flowing out, disconnect the pump return hose (from pump to pool) from the pool inlet fitting.
- b) Attach adaptor A (4) to the sprayer inlet, then connect the pump return hose to the adaptor A. See fig (3). Turn on / plug the filter pump.

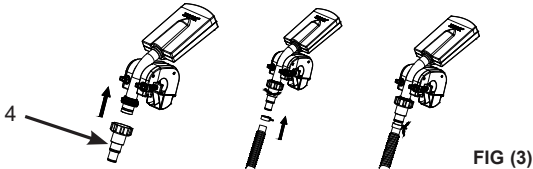

FIG (3)

**Maintenance and Long Term Storage**

1. Regularly check all components for sign of damage, straining. Discard and replace damaged components immediately.
2. Use a sponge and clean water to wipe away any soil or stains.
3. Disassemble the product when the temperature drops below 5°C (41°F) by reversing the above setup instructions, drain the water out of the sprayer, and make sure all components are completely dry before storage.
4. Store the sprayer and accessories in a dry, temperature controlled, between 0° – 40°C (32° – 104°F), storage location.
5. The original packing can be used for storage.

TROUBLE	SOLUTION
LED light is off / flashing	<ul style="list-style-type: none"> <li>• Ensure the filter pump is operating and connect the LED pool sprayer to the water return hose, see “Setup” section.</li> <li>• Check if the pump system flow rate is within the specified range, if the system flow rate is less than 2,271 L/h (600 gph), change pump with higher system flow rate.</li> <li>• Clean or replace the filter pump cartridge. If using a sand filter, ensure the sand media is clean by backwashing it.</li> <li>• Use a garden hose to wash the sprayer head opening, check to see if any sand or deposits in the sprayer head set.</li> <li>• Contact Intex Service Center.</li> </ul>
Poor water cascade performance	<ul style="list-style-type: none"> <li>• Use fingers to wipe away any dirt on the sprayer head opening.</li> <li>• The performance depends on the filter pump flow rate. If you are not satisfied with the water cascade performance, a higher flow rate filter pump is recommended.</li> </ul>
Water spraying out of the pool	<ul style="list-style-type: none"> <li>• The performance depends on the filter pump flow rate, change pump with lower system flow rate.</li> </ul>

# SAVE THESE INSTRUCTIONS

## Limited Warranty

Your MULTI-COLOR LED POOL SPRAYER has been manufactured using the highest quality materials and workmanship. All Intex products have been inspected and found free of defects prior to leaving the factory. This Limited Warranty applies to the MULTI-COLOR LED POOL SPRAYER only.

This limited warranty is in addition to, and not a substitute for, your legal rights and remedies. To the extent that this warranty is inconsistent with any of your legal rights, they take priority. For example, consumer laws across the European Union provide statutory warranty rights in addition to the coverage you receive from this limited warranty: for information on EU-wide consumer laws, please visit the European Consumer Center website at [http://ec.europa.eu/consumers/ecc/contact\\_en/htm](http://ec.europa.eu/consumers/ecc/contact_en/htm).

The provisions of this Limited Warranty apply only to the original purchaser and are not transferable. This Limited Warranty is valid for a period of one (1) year from the date of the initial retail purchase. Keep your original sales receipt with this document, as proof of purchase will be required and must accompany warranty claims or the Limited Warranty will be invalid.

If you find a manufacturing defect in the MULTI-COLOR LED POOL SPRAYER during the warranty period, please contact the appropriate Intex Service Center listed in the separate "Authorized Service Centers" sheet. If the item is returned as directed by the Intex Service Center, the Service Center will inspect the item and determine the validity of the claim. If the item is covered by the provisions of the warranty, the item will be repaired or replaced, with the same or comparable item (at Intex's choice) at no charge to you.

Other than this warranty, and other legal rights in your country, no further warranties are implied. To the extent possibly in your country, in no event shall Intex be liable to you or any third party for direct or consequential damages arising out of the use of your MULTI-COLOR LED POOL SPRAYER, or Intex or its agents' and employees' actions (including the manufacture of the product). If your country does not allow the exclusion or limitation of incidental or consequential damages, this limitation or exclusion does not apply to you.

You should note that this limited warranty does not apply in the following circumstances:

- If the MULTI-COLOR LED POOL SPRAYER is subject to negligence, abnormal use or application, accident, improper operation, improper voltage or current contrary to operating instructions, improper maintenance or storage;
- If the MULTI-COLOR LED POOL SPRAYER is subject to damage by circumstances beyond Intex's control, including but not limited to, ordinary wear and tear and damage caused by exposure to fire, flood, freezing, rain, or other external environmental forces;
- To parts and components not sold by Intex; and/or.
- To unauthorized alterations, repairs or disassembly to the MULTI-COLOR LED POOL SPRAYER by anyone other than Intex Service Center personnel.

Injury or damage to any property or person is not covered by this warranty.

Read the owner's manual carefully and follow all instructions regarding proper operation and maintenance of your MULTI-COLOR LED POOL SPRAYER. Always inspect your product prior to use. This limited warranty will be void if use instructions are not followed.

# SAVE THESE INSTRUCTIONS